

Fe 550 UD

Fe 550UD with lower quantities of carbon, sulphur and phosphorous, helps in preserving the steel and resisting earthquake shocks and fatigue.

Thus making it as the best variant possible made to build futuristic structures.

SRI DURGA TMT IS THE STEEL FOR THE SUPERIOR QUALITY STRENGTH

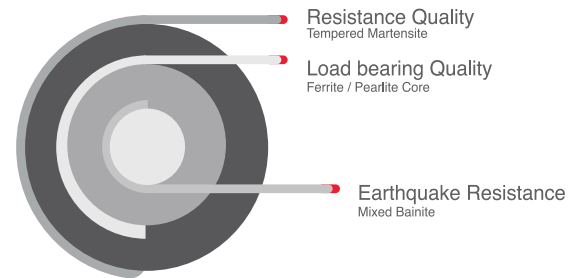
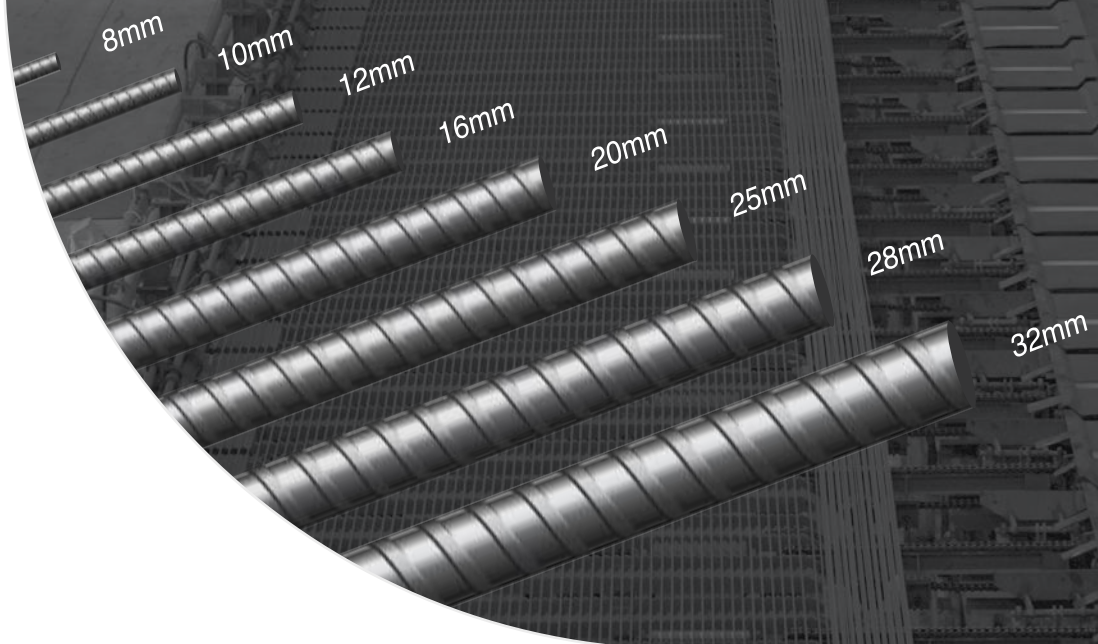

**Three layers
Depicting the
International
Quality**

Product advantages

World Class & Leading-Edge Technology

High Thermal & Fatigue Resistance

Earthquake Resistant

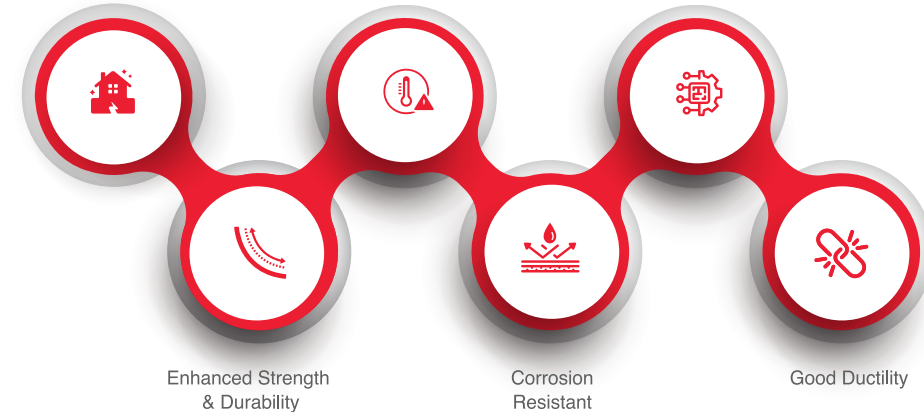

Manufacturing process

- 01 **Raw material**
Sponge Iron
- 02 **Melting Process**
Melting Sponge In Induction Furnace
- 03 **CCM**
Convert Molten Liquid Into Billets In Continuous Casting Machine.
- 04 **Hot Rolling**
Hot Billets are Rolled Directly in TMT
- 05 **Quenching**
Water Cooling of TMT
- 06 **Finished TMT Bar**

KING OF TMT BARS



THE ULTIMATE LEADER



SRI DURGA
TMT BARS Fe 550 UD
The Ultimate Leader



A quality product from sakthi group



www.sakthisteels.com

OUR CLIENTS



SOUTH INDIA'S LEADING STEEL MANUFACTURER

- Tamilnadu
- Andhra Pradesh
- Kerala
- Karnataka
- Telangana



HEAD OFFICE
No.18/26, 2nd Street, Loganathan Nagar, Choolaimedu, Chennai -600094.

FACTORY-1
No.15/1 Abc, 16, 17/1ab 2a, Vasnadu Gollapalee, Kuppam Mandal, Andhra Pradesh, Chittoor-517425.

FACTORY-2
No.223 & 233 Nelvai Thirumukkoodal Road, Amaravathipattinam Village, Kattankulam, Panchayath, Uthiramerur Taluk, Kanchipuram-631606.

Authorised Dealer

093840 97199

crm@sakthisteels.com

www.sakthisteels.com

SRI DURGA TMT STANDARD

Size	Std. Wt. (kg/Mtr.)		Piece Wt. (12.200 Mtr.)		Bundle Wt.		Pieces in Bundle
	Min	Max	Min	Max	Min	Max	
8	0.370	0.380	4.514	4.758	45.140	47.580	10
10	0.580	0.590	7.198	7.442	50.386	52.094	7
12	0.850	0.860	10.492	10.736	52.460	53.680	5
16	1.520	1.540	18.666	19.032	55.998	57.096	3
20	2.420	2.440	29.768	30.012	59.536	60.024	2
25	3.800	3.840	46.604	46.848	46.604	46.848	1
28	4.700	4.810	57.340	58.682	57.340	58.682	1
32	6.200	6.300	75.640	76.860	75.640	76.860	1

Properties	IS:1786-2008	SRI DURGA TMT
Yield Stress-N/mm ² (min)	550	570
Tensile Strength-N/mm ² (min)	585	630
TS/YS Ratio(Min)	1.06	1.10
Elongation %(min)	10.0	16.0
Total Elongation %(min)	NA	NA

CHEMICAL SPECIFICATION

Constituent(%)	IS:1786-2008	SRI DURGA TMT
Carbon(Max)	0.30	0.25
Sulphur(Max)	0.055	0.045
Phosphours(Max)	0.055	0.045
S & P(Max)	0.100	0.080

NOTE: As per BIS, above mentioned mandrels are to be used for bend and rebend the bars. If not use, It will affect the Quality of the Bars.

Providing Best Service to our Clients For more than three Decades!!

400+ Dealers

1300+ Projects

300+ Clients

500+ Employees



SRI DURGA
TMT BARS Fe 550 UD
The Ultimate Leader

Driven by the passion to serve the construction industry and provide greater reinforcement to the structures of future India, Sri Durga TMT a chief division of Sakthi Group at an exponential pace achieved its dominant position in the primary steel market. Striving for quality and enduring strength Sri Durga TMT constantly delivers the supreme grade TMTs.

SRI DURGA TMT IS THE STEEL FOR THE SUPERIOR QUALITY STRENGTH

Accreditation



GOVERNMENT OF TAMIL NADU PUBLIC WORKS DEPARTMENT